

TRANSOM PADS



Outboard Transom Pad, 45 X 36cm C* 7,50 €

Ideal for wide transoms. This pad offers protection against outboard clamp damage and also helps absorb engine vibration. Constructed from rigid UV stabilized, polypropylene with a non-slip surface for secure engine mounting.
Dimensions: 45x36x0,64cm

Code.....125165 236810

Colour.....White Grey

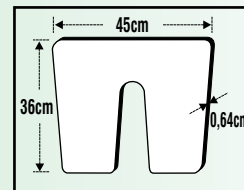

Outboard Transom Pad, 32 X 22cm C* 3,42 €

Offering protection against outboard clamp damage for most sizes of transoms, this pad is constructed from rigid UV stabilized polypropylene with a non-slip surface for secure engine mounting.
Dimensions: 32x22x0,64cm

Code.....125164 236748

Colour.....White Grey

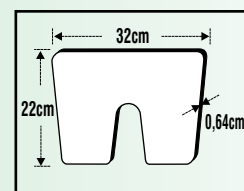

Outboard Transom Pad, 23 X 8,6cm C* 1,55 €

This pad is suitable for smaller transoms and outboards. Made from rigid, UV stabilized plastic, the pad protects against damage whilst providing a secure non slip surface for outboard engine mounting.
Dimensions: 23x8,6x0,5cm

Code.....125163 236713

Colour.....White Grey

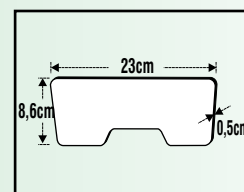

Rail Mount Motor Bracket White, 22,8 x 15cm

Ideal for permanently mounting your outboard on the stern rail instead of storing it when not in use. Constructed from rigid, non-slip UV resistant polypropylene, the bracket provides a secure and stable mount for your auxiliary outboard engine. Designed to fit 25mm diameter rails.
Dimensions: 22,8 x 15 x 4,6cm

A* 126031 27,78 €

20 andere Motorhalterungen
- Modelle lagernd weitere 100 im
Programm Siehe unter anderem
Seite 209 & Seite 22

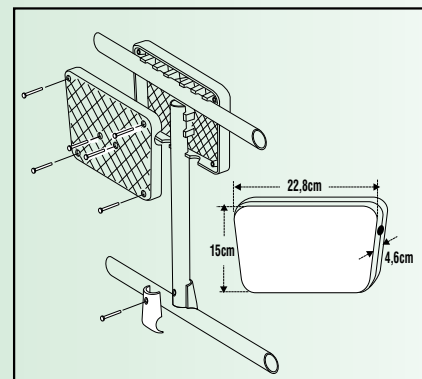

Mounting the Rail Mount Motor Bracket

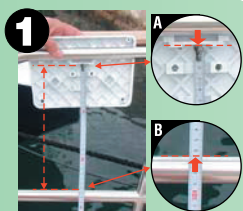

1. Place one part of the bracket on the upper rail and measure the distance between the points shown at pictures A & B.

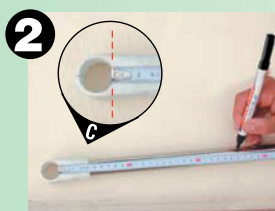

2. Starting from the point shown on picture C, mark the measurement taken at the previous step, and cut the remaining piece (use a cloth so as not to damage the tube)



3. Screw the tube to the lower rail



4. Mount one part of the bracket on the upper rail and the tube. Fit the other part and secure with the screws supplied

