

# Trailerzubehör

## Selbstbremsende Handkurbel-Winden CE und GS geprüft

Diese Winden sind aus Stahl gefertigt, gelb verzinkt und halten durch eine selbsthemmende Sicherheitsbremse die Last ohne Eingriff auf die Handkurbel sowohl beim Hochziehen als auch beim Zuwasserlassen. (Lt. GS nicht zum Heben und Befördern von Personen). Die angegebene Zugkraft ist berechnet bei rollender Last und 30% Steigung.

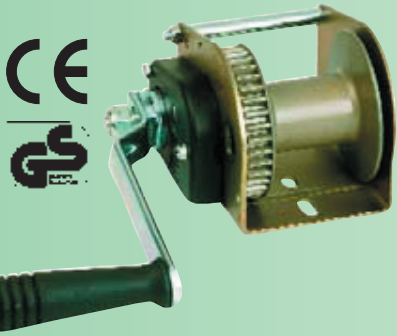

Modell	Zugkraft	Bestell Nr.
4 AF	500 kg	255727 79,90€
6 AF	750 kg	255716 99,90€
8 AF	850 kg	100345 127,00€
12 AF	1500 kg	256124 220,00€

## Handkurbel-Winden aus verzinktem Stahl

Robuste und widerstandsfähige Handkurbel-Winden aus verzinktem Stahl für Anhänger und industrielle Zwecke.

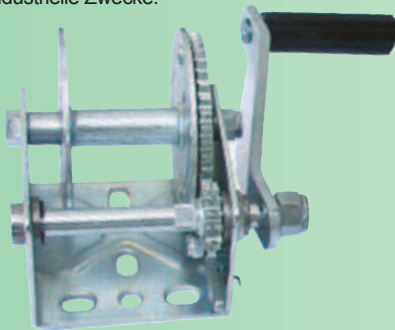

### 1-Gang Winden

Maximale Arbeitslast	Übersetzung	Bestell Nr.
362 kg	3,2:1	197091 16,00 €
455 kg	4,1:1	197131 22,00 €
545 kg	4,1:1	197494 26,50 €
635 kg	4,1:1	121230 38,00 €

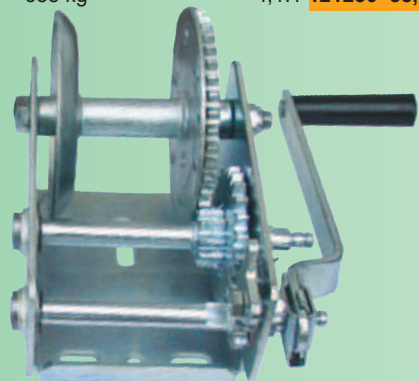

### 2-Gang Winden Typ

Maximale Arbeitslast	Übersetzung	Bestell Nr.
910 kg	4,1:1/9,8:1	100347 56,00 €

## V-Kielrollen aus Hartgummi



Länge	f. SchaftØ	Bestell Nr.
200 mm	16 mm	196499 8,70 €
250 mm	16 mm	196454 9,95 €
300 mm	16 mm	196981 12,50 €

## Kielrollen aus Hartgummi



Länge	f. SchaftØ	Bestell Nr.
115 mm	16 mm	196001 4,50 €
150 mm	16 mm	196070 5,00 €
200 mm	16 mm	196141 6,00 €

## Stevenrolle aus Hartgummi



Länge	f. SchaftØ	Bestell Nr.
75 mm	16 mm	196509 2,50 €

## Boden/Seitenrollen aus Hartgummi



Länge	f. SchaftØ	Bestell Nr.
150 mm	16 mm	196875 4,80 €
200 mm	16 mm	196142 6,00 €
300 mm	16 mm	196567 7,90 €

## Seitenrollen aus Hartgummi



	RollenØ	Rollenbreite	f. SchaftØ	Bestell Nr.
Glatt	100 mm	50 mm	16 mm	196002 4,80 €
Gerippt	110 mm	75 mm	16 mm	196467 7,00 €
	125 mm	75 mm	16 mm	196999 7,50 €

## Bug - Stevenschutz



Montagebasis	Höhe	Weite	Bestell Nr.
50 x 52 mm	75 mm	99 mm	196343 3,00 €
65 x 79 mm	96 mm	149 mm	196003 6,00 €

## Auflagegummi

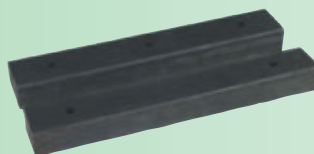

350 x 50 mm	100737 32,20 €
350 x 60 mm	100739 37,80 €
300 x 40 mm mit 4 Bohrungen	103114 6,90 €

Meterware (Rollen zu 20 m), 50 x 40 x 40 mm  
Farbe schwarz 197158 21,00 €



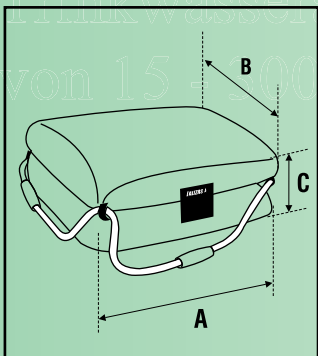

### Life Saving Apparatus - "Cushion Type" A\*

- For use on sail or motor boats.
- Constructed with a durable nylon outer shell and inner layers of polyethylene.
- Complete with all round rope Lifeline.
- Lightweight and doubles as a cushion.
- Available in 3,4 and 6 person models.
- High visibility orange.
- Approved to EEP. Approval number: 4232/24/01.

Code.....	125909	125910	125911
Persons.....	3	4	6
A (cm).....	40	52	46
B (cm).....	50	47	70
C (cm).....	29	25	36
Preis	70,04€	77,78€	94,83 €



### Winch Strap 50 mm

Code	Loading	Length	Preis
236812	2000 Kgs	6m/20ft	7,50 €
236825		7,5m /25ft	8,09 €

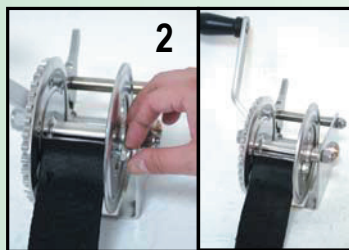

Pass the pin, supplied with the strap, through the hole of the drum, at the spur gear's side and then through the strap loop (picture 1). Screw the bolt to secure the pin on the drums (picture 2).

### Trailer Winch, 3 way, single gear, galvanized auch in Niro lagernd

The Seaware winches are made from corrosion-resistant, galvanized steel for longer life. All winches feature a comfortable handle, 3 positions (forward, neutral and reverse) for safe use and a gear ratio (4:1 – 5.1:1) that maximizes the user's strength. Seaware winches' capacity ranges from 636kgs to 1135kgs.

Code	Capacity	Gear Ratio
11880	1400 lbs / 636kgs	4:1
11881	1800 lbs / 815kgs	5,1:1
11882	2500 lbs / 1135kgs	5,1:1



### Winch cable with hook C\* 8,70 €

Code	Loading	Length	Diameter
236820	1700 Kgs	9m/30ft	5 mm

There are 2 ways to attach the winch cable on the winch.

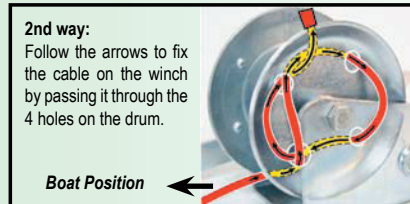
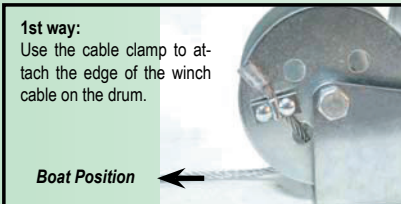

### What is a trailer jack?

A trailer jack is a telescopic pole with a wheel at the end. It is mounted on the frame of the trailer so as to easy load and un-load the trailer from the ball hitch as well as raising the trailer to a proper angle.

### Use:

When you want to release the trailer from the ball hitch, start turning the swivel of the jockey wheel clockwise to lower the wheel. Continue as such until the later reaches the ground and supports the frame of the trailer. It is then safe to unlock the coupling from the ball hitch.

When you want to tow the trailer, lock the coupling on the ball hitch and start turning the swivel counterclockwise. The wheel gradually raises and the frame of the trailer will be supported on the ball hitch. Keep turning the swivel until the wheel is raised completely.

### Safely Tips:

- Ensure that you have completely raised the wheel before towing.
- When cranking or coupling trailer, secure trailer from rolling with chocks on both sides.



### Jockey Wheel

The Seaware jockey wheel is made from high quality steel and features rubber wheel for maximum support of the frame of the trailer. It can reach up to 750mm max. height while the min. height is 500mm.

Code.....	A* 237197 21,38 €
Loading(Kgs).....	360
Min.height (mm).....	500
Max. Height (mm).....	750
Wheel dimensions(mm)....	200x40

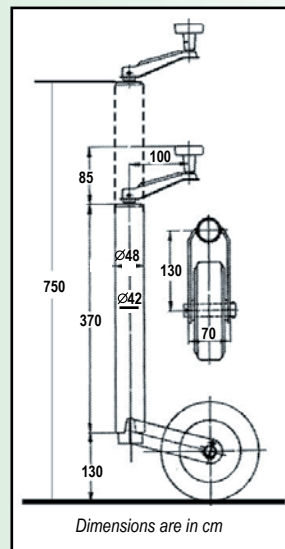

weitere Anhängerwinden auf Seite S 212



**Trailer Coupling, 2000lbs / 900kgs, for 50mm ball ab 12,53 €**

The Seaware trailer couplings have a robust construction and a safe locking mechanism. They lock perfectly on the Seaware ball hitch.

Code.....	A* 237121	12,53 €	A* 237127	14,26 €
A: External length (mm)...	260		260	
B: Internal width (mm).....	54		64	

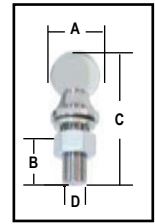

**Trailer Ball Hitch, 50mm 7,80 €**

Seaware ball hitch ensures top performance and many years of service.

Code.....	C* 236815	7,80 €
Loading.....	3500lbs / 1590kgs	
A: Ball Diameter (mm).....	50	
D: Shaft Diameter (mm)....	22	
B: Shaft Length (mm).....	50	
C: Overall Length (mm)....	124	



**Trailer Plug Female, fixed, 7 pin**

Code.....C\* 236753 3,60 €



**Tie Down Strap with self padded buckle**

Code.....	236723	236735	236752
Width(mm).....	25	25	35
Length(m).....	2,5	4	6
Breaking Load(kg). 250	250	500	500
Preis	2,16 €	2,88 €	3,60 €



**Trailer Plug Male, 7 pin, for 11887 plug**

Code.....C\* 236744 3,42 €



**R Gurt mit doppelten J Hacken ab 8,10 € C\* B\* A\***

Code.....	236817	236838	237150
Width(mm).....	30	35	50
Length(m).....	6	7	8
Breaking Load(kg). 1500	1500	2500	5000
Preis	8,10 €	9,76 €	18,14 €



**Ratchet Tie-Down with S hook C\*ab 3,45€**

Code.....	236749	236761	236754	236765
Width(mm).....	25	25	25	25
Length(m).....	3	6	3	6
Breaking Load(kg). 250	250	500	500	500
Preis	3,45 €	4,20 €	3,75 €	4,50 €



**Welcome Mat with backing, PVC A\* ab 8,43 €**

Code.....	125443	125441	125444	125442
Colour.....	Grey	Blue	Grey	Blue
Dimensions(cm)....	40X60	40X60	60X90	60X90
Preise	8,43 €	8,43 €	11,92 €	11,92 €



**Marine Carpet with backing, PVC**

Code*.....	125930	125928	125929	125927
Colour.....	Grey	Blue	Grey	Blue
Width(cm)...	90	90	120	120

\* Sold by linear meter

**Marine Carpet without backing, PVC**

Code.*.....	125932	125931
Farbe.....	Grey	Blue
Width(cm)...	120	120

\* Sold by linear meter